

MOSCOW

AN ICONIC CITY LANDMARK
HOME TO A WORLD-RENOWNED
BAR AND A FINE RESTAURANT,
WITH PANORAMIC CITY VIEWS
FROM A STYLISH SETTING

Swissôtel Krasnye Holmy, Moscow

Kosmodamianskaya emb., 52 building 6, Moscow 115054, Russia
Tel +7 495 787 9800 Fax +7 495 787 9898
moscow@swissotel.com www.swissotel.com/moscow

swissôtel **KRASNYE HOLMY**
MOSCOW

LOCATION

AT THE HEART OF EVERYTHING YOU NEED

You'll like that we're centrally located. Swissôtel Krasnye Holmy Moscow is only a 45-minute drive from Moscow Domodedovo airport in a trendy new business and cultural area that is also close to the Kremlin and Red Square. Settle into our comfortable armchairs and inviting workspaces, or work with our dedicated meeting specialists to plan your event. Our in-house restaurants and bars are inspiring meeting places offering international and local cuisine infused with exquisite ingredients and organic products from Russian farmers. Would you like to work out? Relax? Pürovel Spa & Sport offers you inviting options for both.



GUEST ROOMS

234 REASONS TO RELAX

With 234 beautiful rooms and suites, it's easy to come to Moscow and leave the world behind. Floor-to-ceiling windows in the curved Panorama rooms offer impressive views of Moscow's skyline. So kick off your shoes and enjoy the cityscape in the comfort of your own space. Business travellers staying in our Swiss Business Executive Club rooms and suites have access to the Swiss Executive Club Lounge complete with a meeting room, private workstations and exclusive amenities. Looking to stay somewhere extra special? A VIP experience awaits you in our new Penthouse Suite. Sit back, relax and take in the breathtaking view of Moscow from your private Jacuzzi.

RESTAURANTS & BARS

CITYSCAPE SETTING

The stage is set for a breathtaking time in City Space Bar & Restaurant. Step into the elevator, select the 34th floor and see how we take the dining experience to new heights. Savour the 360-degree panoramic views across Moscow as you sample our signature cocktails and pan Asian cuisine.

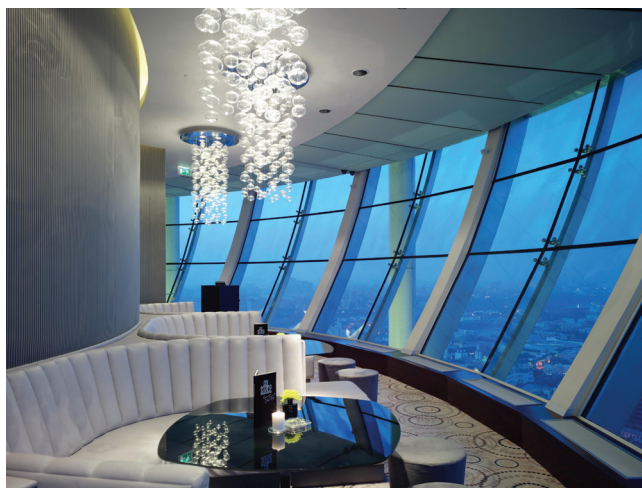

PÜROVEL SPA & SPORT

TAKE TIME FOR YOU

Spring. Summer. Fall. Winter. Thanks to Pürovel Spa & Sport, it's possible to experience the four seasons of natural vitality in one short stay. Take time out of your busy schedule to enjoy the naturally lit pool area with hydro massage and Jacuzzi, fitness area, treatment rooms and sauna.



CONFERENCES, MEETINGS & EVENTS

INVITING SPACES THAT LEAVE A LASTING IMPRESSION

Swissôtel Krasnye Holmy Moscow is a memorable location for an event. Beautiful ballrooms overlook the city while spacious conference halls are flooded with natural light. Take in the skyline views from the Davos ballroom and meeting rooms located on the 29th floor, while Zurich hall, complete with a large foyer area, is the perfect setting for large-scale events. Whether for international conference or an exclusive and more intimate meeting, our facilities, service and specialist team are guaranteed to leave a lasting impression.



FACILITIES & SERVICES

SWISSÔTEL KRASNYE HOLMY HIGHLIGHTS

- Centrally located 5-star hotel
- 234 beautiful and contemporary rooms and suites
- 45 minute drive from Moscow Domodedovo airport
- Airport transfers
- In-house restaurant and bars
- Swiss Business Executive Lounge
(for Swiss Business Executive floor rooms and above)
- Professional conference, meeting and event facilities spanning a total of 770 square metres
- Wireless internet
- Pürovel Spa & Sport centre
- 24-hour in-room dining
- 24-hour concierge service
- Car park with 40 parking lots

CAPACITY CHART

MEETING ROOMS	AREA FT²	AREA M²	L	W	H	BOARDROOM	BANQUET	SEMINAR	U-SHAPE	CONCERT	COCKTAIL
LEVEL 1											
Lausanne	279	26	7.2	3.8	3.5	10	-	-	-	-	-
Basel	379	35	8.1	4.2	3.5	12	-	-	-	-	-
Lucerne	379	35	81	4.2	3.5	14	-	-	-	-	-
Geneva	444	41	7.8	7.2	3.5	14	-	14	16	26	20
Lucerne + Geneva	827	76.5	12.3	8.1	3.5	26	50	30	24	50	45
Zurich 1 + 2	1791	166.5	16.5	10.9	4	44	100	100	50	120	14 with Foyer
Foyer area Zurich	1473	137	-	-	-	-	-	-	-	-	120 for coffee breaks
LEVEL 29											
Davos 1 + 2	1599	148.5	24.1	7.1	3	48	100	70	42	80	120
Foyer area Davos	537.8	50	-	-	-	-	-	-	-	-	80 for coffee breaks
Boardroom	434	40	7.3	7	3	14	10	-	12	20	20
Zermatt	229	21	5.1	4.3	3	10	10	-	-	-	-

LEGEND

- Meeting Room or Ballroom
- Restrooms
- Escalator
- Elevator
- Food & Beverage Outlet
- Emergency Exit
- Stairway
- Window
- Moveable Partition

LEVEL 1

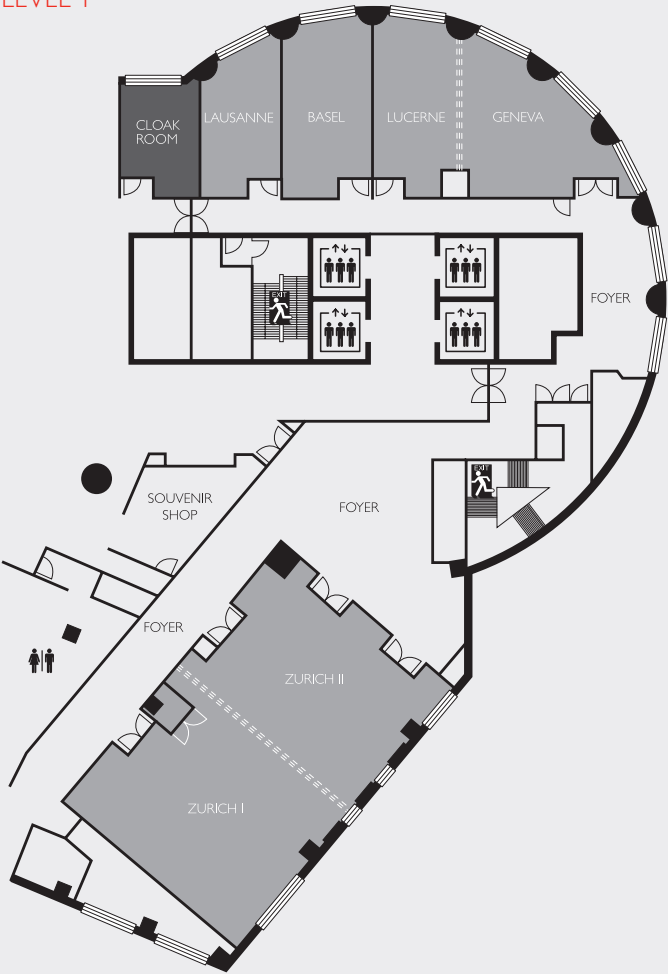

LEVEL 29

